

ORDINANCE NO. 2984

Ordinance to adopt a Land Use Map amendment to the City of Greenfield Comprehensive Plan for the property located at 10375 and 10401 W. Oklahoma Ave. from Planned Business to Community Facilities. (Tax Key No. 524-8984-009)

WHEREAS, the City has prepared the Land Use Map Amendment pursuant to Wis. Stat. § 66.1001; and,

WHEREAS, the planning process for the Land Use Map Amendment was open to the public and numerous efforts were made to assure the broadest participation to establish the goals and elements considered for and contained within the plan in compliance with Sec. 66.1001 of the Wisconsin Statutes; and,

WHEREAS, on July 13, 2021, the City of Greenfield Plan Commission by majority vote recommended that the Common Council approve an ordinance for the subject Land Use Map Amendment to the City of Greenfield Comprehensive Plan in compliance with the requirements of Sec. 66.1001(4)(b) of Wisconsin Statutes; and,

WHEREAS, the Common Council of the City of Greenfield conducted a public on September 21, 2021, upon a proposal to amend the Land Use Map to the City of Greenfield Comprehensive Plan; and,

WHEREAS, Notice of said hearing has been duly published in the official City of Greenfield newspaper and a period of at least thirty (30) days has expired after the last publication before said hearing, as required by State Statues; and,

WHEREAS, following the Public Hearing and upon consideration of the Plan Commission's recommendation, and all public comment received at the hearing, the Common Council finds that the proposed amendment furthers the coordinated, adjusted and harmonious development of the City which will, in accordance with existing and future needs, best promote public health, safety, morals, order, convenience, prosperity or the general welfare, as well as efficiency and economy in the process of development.

NOW, THEREFORE, the Common Council of the City of Greenfield do ordain as follows:

PART I. The Greenfield Common Council, does by enactment of this ordinance, pursuant to Sec. 66.1001(4) of the Wisconsin Statutes, formally adopt the subject Land Use Map Amendment to the City of Greenfield Comprehensive Plan to redesignate the Future Land Use Map within the City's Comprehensive Plan (Chapter Three: Land Use) from Planned Business to Community Facilities (Tax Key No. 524-8984-009), Greenfield, Milwaukee County, Wisconsin,

(map attached as Exhibit A hereto and incorporated herein by reference) more particularly described as follows:

Parcel 1 of Certified Survey Map No. 4208 and the Westerly 77.91 feet of the North half of a vacated alley, all being a part of the Northwest ¼ of Section 17, Township 6 North, Range 21 East, in the City of Greenfield, Milwaukee County, State of Wisconsin.

Tax Key No. 524-8984-009

PART II. The terms and provisions of this ordinance are severable. Should any term or provision of this ordinance be found to be invalid by a court of competent jurisdiction, the remaining terms and provisions shall remain in full force and effect.

PART III. All ordinances or parts of ordinances contravening the provisions of this ordinance are hereby repealed.

PART IV. This ordinance shall take effect and be in force from and after its passage and publication.

PASSED AND ADOPTED by the Common Council of the City of Greenfield on the 27th day of September, 2021.

APPROVED:

  
Key: 27e4e3d94458b272d3835b435e7d9e72

---

Michael J. Neitzke, Mayor

ATTEST:

  
Key: 9ca809a42d4cb3fc4c4a85b201d09d4e

---

Jennifer Goergen, City Clerk

Published: October 6, 2021

## Exhibit A: Parcel to be amended

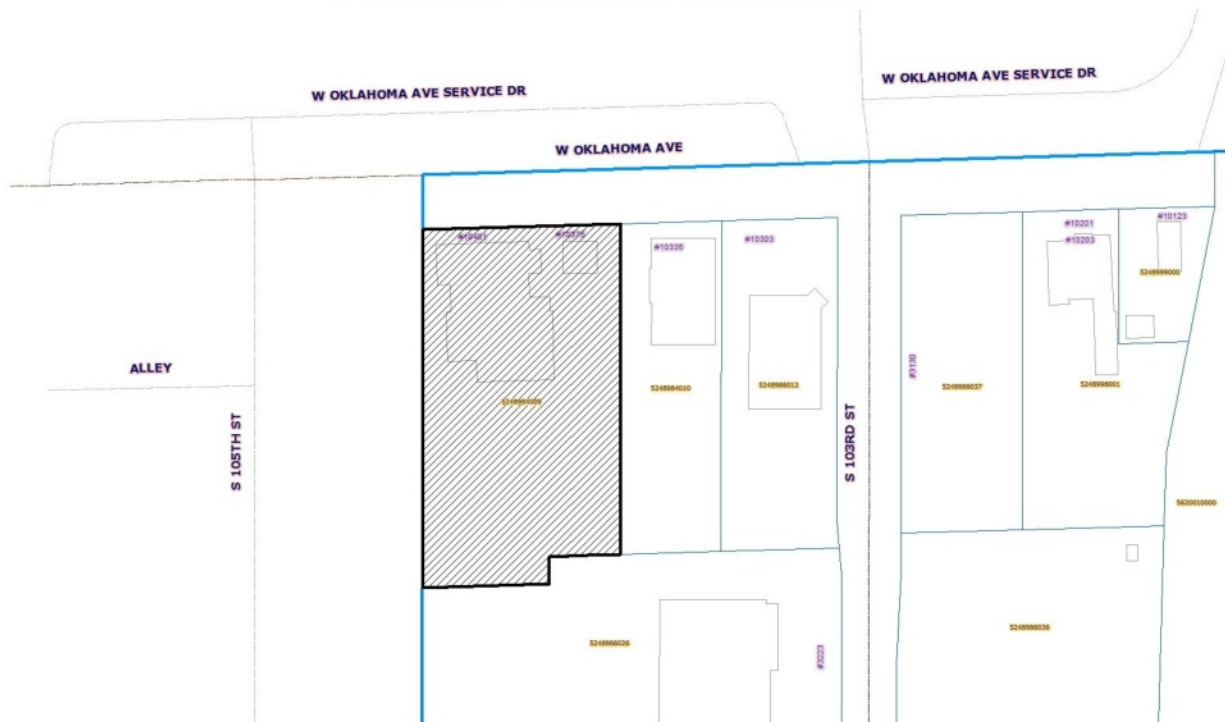

## Exhibit B: Existing Comprehensive Land Use Map

