

Return this form 2 weeks (10 business days) prior to your event to the Parks & Recreation Office (Greenfield City Hall Room 200 M-F 8AM-5PM)

Group Name _____

Event Date _____

Approx. Guests Attending # _____

Arrival Time _____ - _____

We will be having a DJ

Name of DJ (First & Last)

Phone # _____

Arrival Time _____

We will be having a Caterer/Food Truck

Name of Caterer/Food Truck

Phone # _____

Arrival Time _____

Flags Displayed

Yes No

Divider Wall between A & Oakley Fisher

Opened Closed

STANDARD SET-UPS

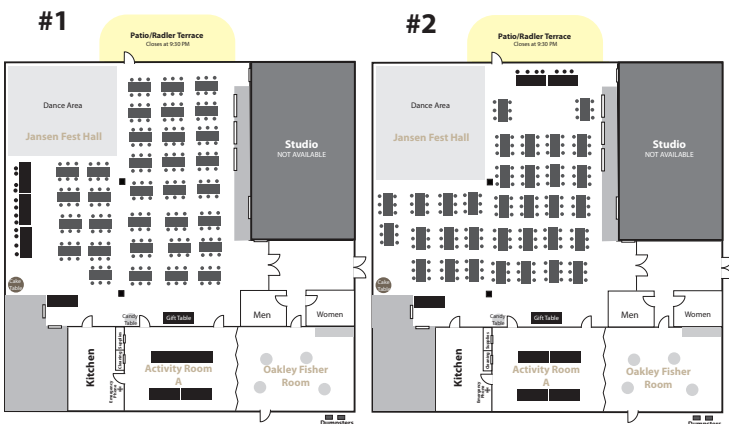

AVAILABLE TABLES

Qty=33 (Seats 6)	Qty=8 (Seats 8)	Qty=6 (Seats 5-6)

